

B32

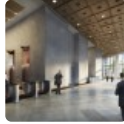

Click an image to view larger version.



Figures

Height: Architectural	125.6 m / 412 ft
Height: Occupied	110.4 m / 362 ft
Height: To Tip	125.6 m / 412 ft
Height: Helipad	125.6 m / 412 ft
Floors Above Ground	27
Floors Below Ground	7
# of Elevators	23
Top Elevator Speed	7 m/s
Tower GFA	60,000 m ² / 645,835 ft ²
Development GFA	120,000 m ² / 1,291,669 ft ²
# of Parking Spaces	1,400

Facts

Official Name	B32
Other Names	Birmann 32, Faria Lima 3732
Structure Type	Building
Status	STO
Country	Brazil
City	São Paulo
Street Address & Map	Avenida Brigadeiro Faria Lima, 3732
Postal Code	04543-060
Building Function	office
Structural Material	concrete
Energy Label	LEED Certified
Construction Start	2014
Completion	2020
Official Website	B32

Companies Involved

Developer	FLPP Faria Lima Prime Properties SA; Birmann
Architect	<ul style="list-style-type: none"> Design: Pei Partnership Architects; Eiji Hayakawa Architects Architect of Record: Contier Arquitetura; Collaco e Monteiro
Structural Engineer	<ul style="list-style-type: none"> Design: JKMF; Kurkdjian & Fruchtengarten Engenheiros Associados
MEP Engineer	<ul style="list-style-type: none"> Design: WRS; Teknika; SKK Engenharia Peer Review: Jaros, Baum & Bolles
Project Manager	DVLP
Other Consultant	<ul style="list-style-type: none"> Access: Bosco & Associados Acoustics: Acústica & Sônica Civil: FCH Consultoria; Monobeton Façade: Vidaris, Inc.; AJLP; Crescência Petrucci Façade Maintenance: Lerch Bates Food Service: Placontec Foundation: Consultrix Engenheiros Associados Ltda. Landscape: Thomas Balsley Associates; Gracielli Folli LEED: Atelier Ten; ENE Consultores Lighting: Studio IX Marketing: Neorama Vertical Transportation: Barker Mohandas, LLC
Material Supplier	<ul style="list-style-type: none"> Elevator: thyssenkrupp